



**4,723 SF AVAILABLE**



# New Retail Development – Rumford, RI

75 Newport Ave  
Rumford, RI 02916



Gabriel Schuchman | 248.646.9999 | gabe@alrigusa.com  
Faith Fruciano | 248.983.5520 | faith@alrigusa.com





142 New Apartments  
(Under Construction)

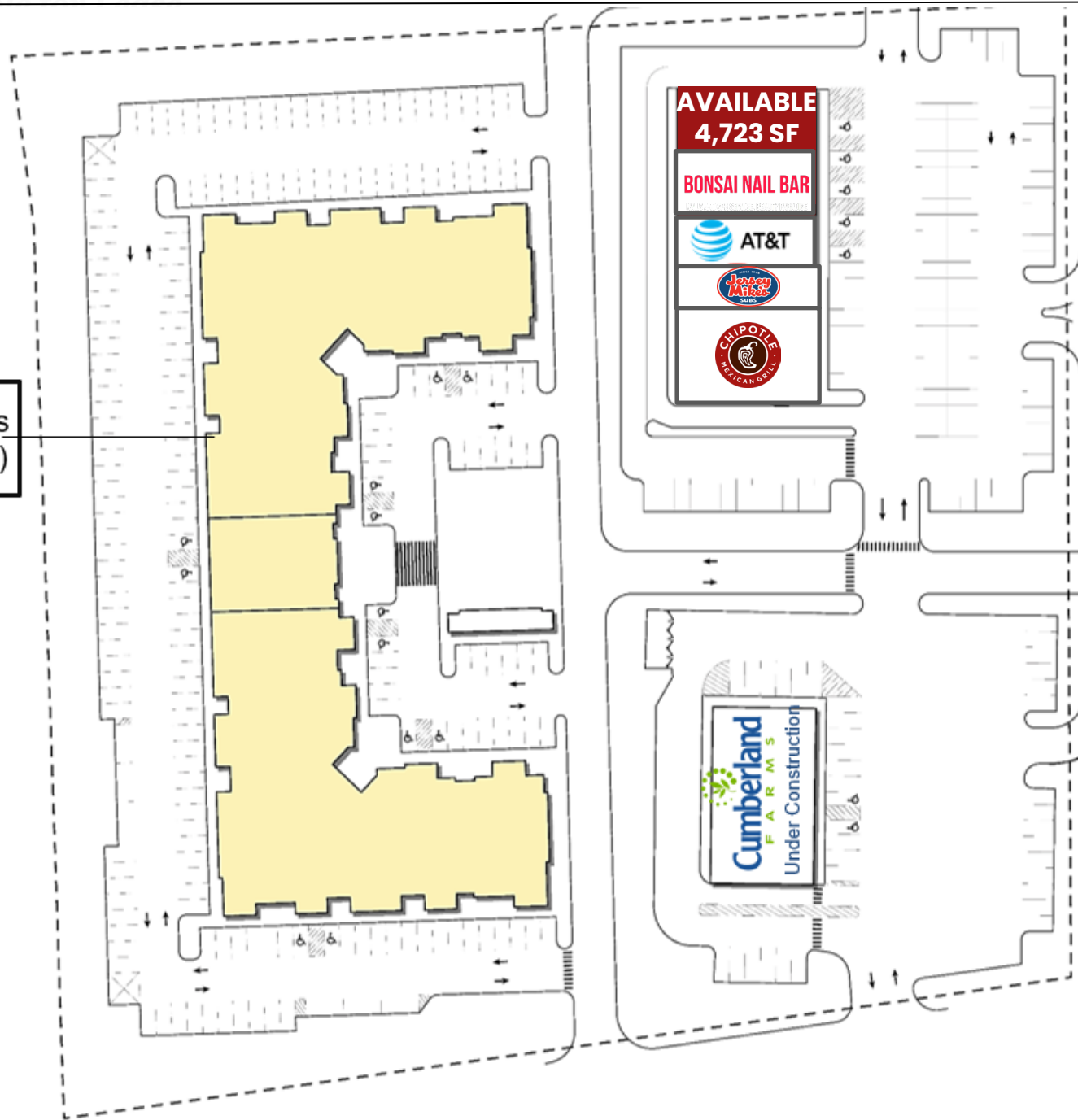



**Current Construction Photos**







# New Retail Development – Rumford, RI

Available for Lease

## Property Address

75 Newport Ave Rumford, RI 02916

## Property Highlights

- Join Chipotle, Jersey Mikes and AT&T in this brand new retail development on the outparcel to mixed-use project, featuring 142 new apartments
- Located on the hard corner of Moore Street and Newport Avenue with up to **4,723 SF** of retail available for lease
- Located in Rumford neighborhood on East Providence RI which is witnessing many new developments
- Excellent retail synergy along 24th Avenue
- Nearby retailers include Aldi, McDonalds, Burlington, CVS and Honey Dew Donuts

## City Overview



The John Hunt House is a popular tourist attraction as it serves as the foundation for the historic society



Rumford baking powder was made in the early days of the town, ultimately leading to the name of the city as Rumford



Popular attractions are the cathedrals and churches, known as the “Mountain of Fire & Miracles Miniseries”



Hunts Mill Trail leads the way to breathtaking waterfalls

## Property Availability

**4,723 SF** available for lease

Demographics	1 Mile	3 Mile	5 Mile
 Population	10,486	120,553	291,181
 Households	4,324	50,199	113,819
 Average HH Income	\$87,724	\$82,529	\$79,267
 Daytime Employment	6,682	58,466	189,696

©ALRIG USA Inc. This information has been obtained from sources believed reliable. We have not verified it and make no guarantee, warranty or representation about it. Any projections, opinions, assumptions or estimates used are for example only and do not represent the current or future performance of the property. You and your advisors should conduct a careful, independent investigation of the property to determine to your satisfaction the suitability of the property for your needs. Photos herein are the property of their respective owners and use of these images without the express written consent of the owner is prohibited ALRIG USA and ALRIG USA logo are service marks of ALRIG USA and/or its affiliated or related companies in the United States and other countries. All other marks displayed on this document are the property of their respective OWNERS.